



'Genuine' benefits ring true

Because 'copy' equipment can be so difficult to identify, it may be hard to avoid mixing it into a scaffold structure – and that could lead to serious problems.

Layher is very clear about what it sees as one of the most significant potential risks facing the industry. Taking steps to ensure only genuine equipment is used, Layher believes, is the most effective way of offsetting the risk.

Compromising safety is clearly top of the list of problems that the use of non-genuine equipment in a structure could create because scaffolding integrity could be affected. In turn this may also invalidate guarantees, affect insurance and damage corporate reputation. Layher believes that all scaffolding users should check with their supplier to ensure there is no risk of mixing copy and original equipment – whatever the size of the installation or type of application.

A founder member of OSEM, the Original Scaffolding Equipment Manufacturers group which highlights questions that users should ask via its website –

www.dontmixit.org – Layher is strengthening the message through a series of advertisements, emphasising the key points of the issue. Layher can supply details relating to design, material specification and manufacturing processes to help avoid a risk that it believes is simply not worth taking.

**Ensuring
the safety of
scaffolders**

In this issue...



• From scaffolding to roofing protection, and from access to dedicated event systems – the proven Layher range meets all on-site requirements....page 2



• Innovation, clever design and an understanding of market needs, demonstrated by highlights from the extensive range of component options detailed inside.....pages 2 & 3



• Designed to make refurbishment and new build projects as effective and efficient as possible – two examples 'in the field' produce clear benefits.....page 4

■ ALLROUND® SCAFFOLDING

■ FALSEWORK

■ PROTECTIVE SYSTEMS

■ EVENT SYSTEM

■ ROLLING TOWERS

■ LADDERS

■ SPEEDYSCAF®

■ ACCESSORIES

Beware of imitations!

Make sure you don't risk –

- lives, and compromise safety
- scaffolding integrity
- invalidating guarantees or insurance
- damage to your reputation

Eliminate mixing equipment on site – call us now: **More Possibilities. The Scaffolding System.**

Layher.

Layher Ltd., Works Road, Letchworth, Hertfordshire SG8 1WL
Tel 01462 475 100 Fax 01462 475 101 E-mail info@layher.com www.layher.co.uk

Highlighting an important potential risk – one of the current series of Layher advertisements.

The days of claiming modular scaffolding is 'not versatile' are long gone. Apart from offering an extensive choice of purpose-designed systems (see panel below left), Layher is also dedicated to developing innovative solutions to meet specific on-site installation requirements. From components designed to maximise safety to those developed to make site work more efficient and easier – the selection highlighted below represents just a few examples of Layher's on-going commitment to listening to its customers' needs.

Make more out of Allro

ALLROUND® SCAFFOLDING
Maximised installation versatility centred on Layher's acclaimed 'rosette' design.

PROTECTIVE SYSTEMS
From 'Protect' containment panels to a choice of temporary roofing systems – all designed to help maximise efficiency and improve the building environment.

ROLLING TOWERS
Fast to erect, easy to reposition, safe and with a choice of decking sizes – the optimum answer to mobile access.

SPEEDYSCAF®
Simple, manual erection using just five basic components to create a strong, stable access system.

FALSEWORK
With a few additional components, Allround® can easily be converted into a falsework system offering back-propping, crash-deck and load support solutions.

EVENT SYSTEM
Dedicated equipment designed to be expandable and adaptable – meeting a vast number of concert and sporting event staging, stand and platform requirements.

LADDERS AND STAIRTOWERS
Direct stairtower connection to scaffold design provides safe, durable access for multiple personnel use at any height – together with a choice of ladder designs that all offer durability, stiffness, safety and stability.

ACCESSORIES
From steel or aluminium unit beams, scaffold tubes, couplers and castors to hoists, nets, wall anchors and hardware, the choice of optional accessories from Layher is innovative and extensive – to maximise the success and effectiveness of every installation.

Pivoting guard rail, 0.73 or 1.0 m

Safe access from a ladder up onto a scaffolding platform is assured by these pivoting guard rails. Whether attached on the left or right, the automatic closing function is maintained. For 0.73 m or 1.0 m wide entrances. Modified version with integral steel toeboard now available.

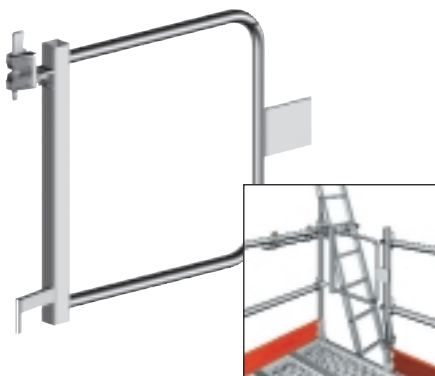

REF. No. 2627.004 0.73 WIDE

REF. No. 2627.005 1.0 M WIDE

Double wedge head coupler

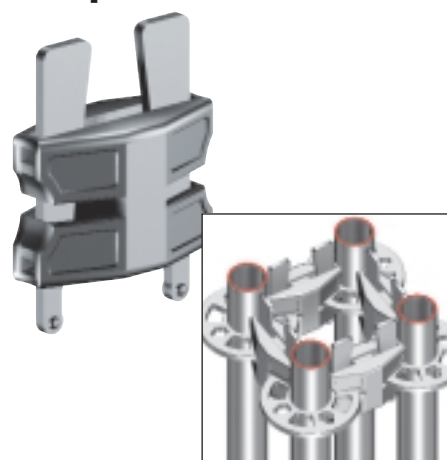

Ties Allround® standards to make supporting towers with extremely high load bearing capacities (15 tonnes). Application ranges from standards bundled in multiples or connected to towers and extended spatial structures.

REF. No. 2628.000

Rigid wedge head coupler

For connection of scaffolding tubes (dia. 48.3 mm) to the Allround® rosette – not only for stiffening braces in support scaffolding, but also to allow tube and coupler guardrails to be connected to Allround® whilst maintaining the correct hand rail height.

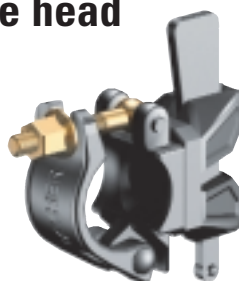

REF. Nos. 2628.019/022

Swivel wedge head coupler

For connection of scaffold tubes (dia. 48.3 mm) to the Allround® rosette. Allows variable connection angles with traditional scaffolding tubes.

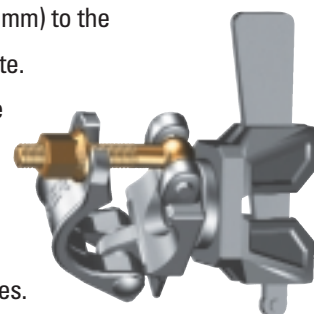

REF. Nos. 2629.019/022

A commitment to on-going innovation provides unrivalled technical solutions to meet a vast range of installation requirements.

und[®] equipment

Clamp-on rosette coupler

Rapid intermediate connections to Allround[®] standards are achieved – with dependably high connection values for up to six ledgers or diagonal braces per rosette.

REF. Nos. 2602.019/022

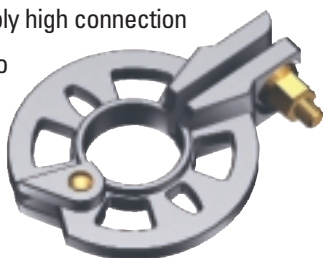

Gap deck, 0.73 - 3.07 m x 0.11 m

Layher has a perfect solution to hand even for the smallest gap. Safety is assured with the wedge head connections directly into the rosettes, obviating the need for an inside ledger (thereby removing the perceived trip hazard).

REF. No. 0713.689 = 0.73 M LONG

REF. No. 0714.269 = 1.09 M LONG

REF. No. 0714.270 = 1.40 M LONG

REF. No. 0714.271 = 1.57 M LONG

REF. No. 0714.272 = 2.07 M LONG

REF. No. 0714.273 = 2.57 M LONG

REF. No. 0718.903 = 3.07 M LONG

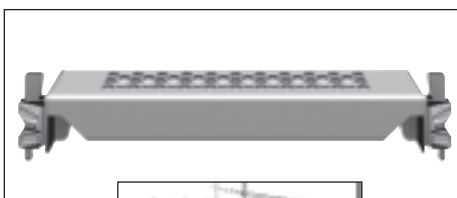

Beam bracket, with two wedge heads

This unique component allows for the connection of non-system lattice girders. The 450 mm alloy beams fix into the spigots of the beam brackets with the wedge heads then connecting directly into the Allround[®] rosettes, thereby systemising the 450 beam.

REF. No. 0702.835

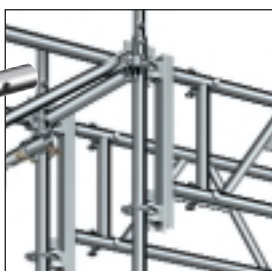
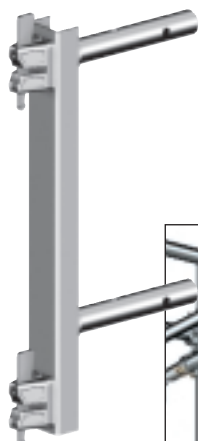

Rosette with thread insert

Fits onto the spindle of the adjustable base plate, where large adjustments have to be made. Fitting with diagonal braces is therefore consistent.

REF. Nos. 2602.119/122



The extensive choice of components from Layher helps to maximise installation effectiveness every time.



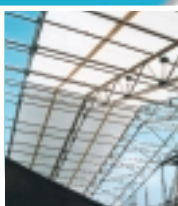

Keder system plays a key role at the prestigious Murrays' Mills refurbishment site in Manchester

The regeneration of Murrays' Mills in the Ancoats area of Manchester to create a series of impressive canal-side duplex apartments has gained from the use of the Layher Keder roof system.

The project, for the Ancoats Buildings Preservation Trust via main contractor Wates, has included extensive works on the original 200 year old roof trusses so protection from the elements has been vital. The Keder sheet system that uses just two key components attached to the Layher apex roof framework, creates a taut

structure which is effective, tidy and permits natural light to enter.

Simplicity of erection, light weight and the ease with which sections can be removed have been clear benefits – "We were delighted to work on the project with Allied Scaffolding at the site," says Layher's UK Managing Director Sean Pike, "which included the system being fixed to the top of a conventional tube and fitting scaffolding, demonstrating an important feature of the Keder roof design."



The Layher Keder roof system has brought tangible benefits to the refurbishment of Murrays' Mills in Manchester.

Allround® benefits for block and timber housing

The benefits of quick erection times and flexible options – such as hop-up platforms – are key features of the Layher Allround® system being enjoyed by block and timber housing builders.

A prime example is seen with R.Bau in the North East, a leading proponent of continental systems and rapid build methods, whose focus on erecting brickwork and either blockwork or timber frame structures – importantly to full height in a single phase of a construction project – is complemented by the Layher Allround® system which keeps pace with the build speed.



Layher Allround®, seen here with a stair system, keeps pace with the building programme in South Shields.

Paul Webster, Managing Director of R.Bau, highlights a Bellway Homes project at Cleadon Park in South Shields as an example. The site also features Layher stair systems to provide safe

access and egress and the company's loading bay gate system to optimise material access. During the initial phases of construction the joiners working for Stewart Milne Timber Systems, who provided the timber frame house kits, commented that it was "the best scaffold they had ever worked on."

It is an innovative approach to house building that is gaining greater favour throughout the market in this country. The combination of Layher equipment and support training is helping leading builders in the field to make the most of this growing opportunity.

Hot off the press

The new Layher Allround® loading tower bay and gate is easily and quickly assembled using Allround® scaffolding parts and helps to meet the requirements of the Work at Height Regulations 2005.



New Layher Allround® telescopic decks extend from 1.57 m up to 2.57 m to infill gaps in scaffolding structures that do not meet the standard modular sizes.

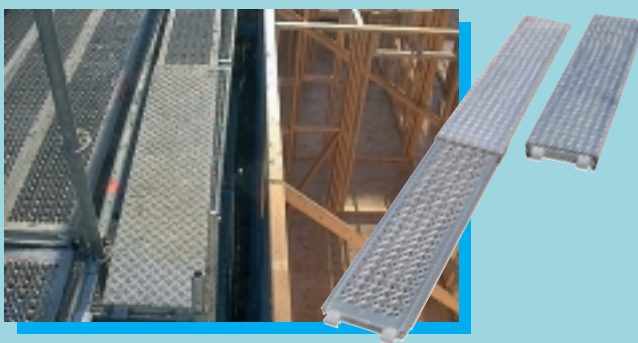

To take full advantage of our range, our experience, our commitment – contact us now via the details below